



EXAMPLE PROJECT 1

Gatwick Airport 'MegaFIDs' in South Terminal

Client: Gatwick Airport / Mansell Construction

Project Value: Circa \$300,000

Timeframe: 4 months from initial design to commissioning

Date: May – Jan 2014



The brief for the Gatwick 'MegaFID' was to create 2 high impact flight information screens at full HD resolution per screen panel.

Gatwick Airport were in the middle of a large refurbishment of the South Terminal Departure lounge, with Mansell construction being the primary contractor for the building works.

ADXBA were asked to work alongside Mansells as the digital specialist, to fully design, fabricate, install and configure the 2 units. Working closely with the Gatwick Projects Team, Airport stakeholders and Mansell Construction, our dedicated PM arranged for detailed drawings and structural plans to be made, so we were able to create visual renders of the area. From this, and with stakeholder approval, the designs we recreated and full CAD drawings for fabrication.

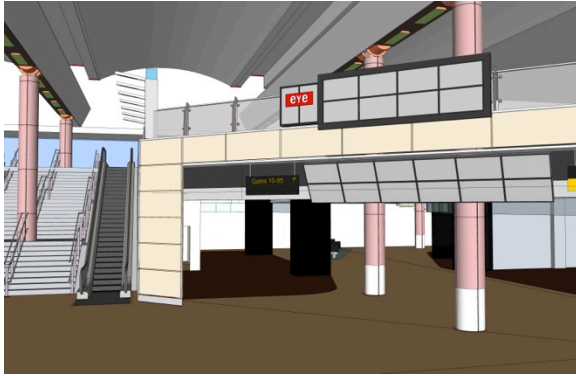

The next stage of the project was to liaise and link in with other sub-contractors of Mansell, such as electricians and network engineers. With specific working windows in the build process, we installed the PC hardware and network infrastructure in a GAL Coms room - Video over cat6 was installed to each of the 12 screens in 6x2 video wall – giving each screen full HD and a total resolution of 11,520 pixels by 2,160 pixels!

The installation had to be completed in 2 core stages.

First, 3 steel beams needed to be bolted to the underside of the upper floor to hang the screens and their framework. Structural calculations and pull-tests were submitted before hanging the main structure.

Next, the main frames and screens we installed by our team of professional installers/engineers.

To complete the project, the Flight information feeds from the AODB (Airport Operational Database) were configured to show live flight information to passengers in the South Terminal.

These 2 units were part of a larger, Terminal wide installation of MegaFID's at Gatwick – all designed, fabricated and installed by ADXBA. The first was installed in October 2012, and all have been running without fault since install.

The images below show some of the other MegaFID's installed:

